

Smart Pet Feeder(WiFi) Instruction Manual

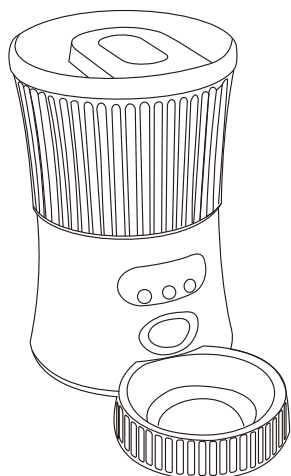

Tuya Smart



Structure of equipment

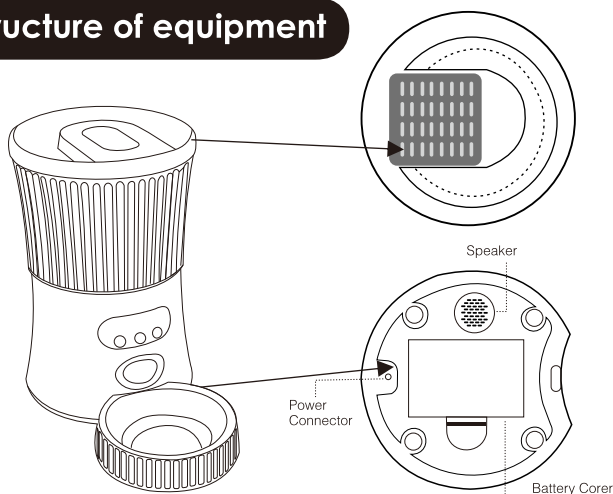

Control panel

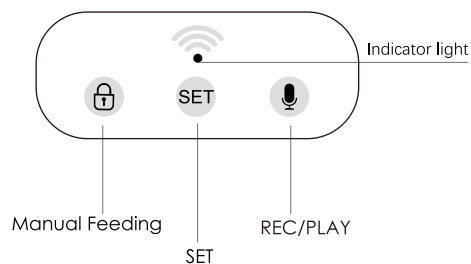

App download and install



Scan QR code to download and install it.

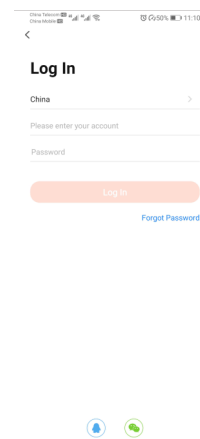
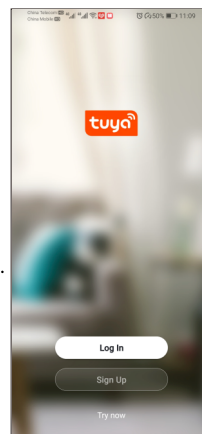

Register Account with Mailbox or Authorized Login after finishing Installing .

Ready for connect:

- Power Adapter output voltage : 4.9-5.3V**
- 1. Connect the power cable with feeder
- 2. Please connect your mobile phone to **2.4G WIFI**
- 3. Turn on your phone's bluetooth
- 4. Make sure there is a good signal connection between the feeder, mobile phone and WiFi.

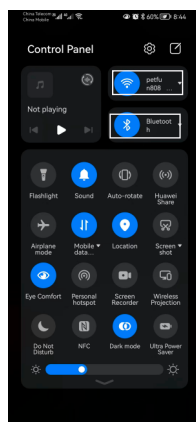

Recording

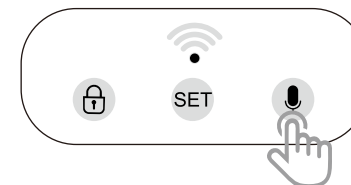

1. Long press "REC/PLAY", the device begin recording after "D!" .Release your hand , the device ends recording after "DIDI"
2. Short press "REC/PLAY", the device plays the recording.

Clean the rotating structure



1. Turn clock wise, take out food bucket



2. Take out and turn upwards rotating structure



3. Wash and wipe clean

Connect and Binding the Device

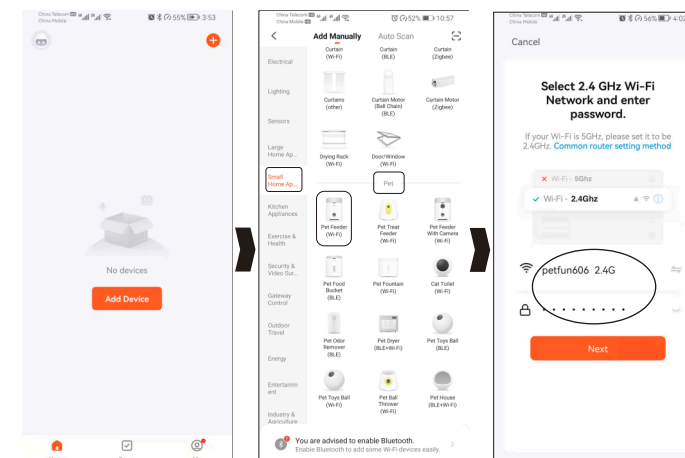

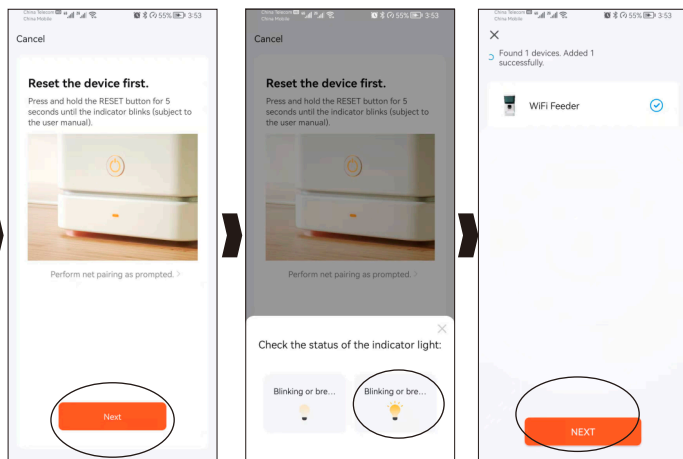

**The device should be placed near the router.
Plug in the adapter and switch on the power.**

Method 1: select the device manually

Open the App, and Click "+" Button, Pop-up Device List,

1. Select "Small Home Ap...",
2. Select "Pet",
3. Select "Pet Feeder (Wi-Fi)".
4. Select the 2.4GWi-Fi network and enter the password (5G network is not supported).
5. Confirm that the device green light blink quickly (flashes 2 times/second).
6. Equipment networking.
7. Devices connected successfully.
8. After the networking is successful, click "Done" in the upper right to enter the feeding page.

Turn on your phone's Bluetooth, the device will be discovered automatically.

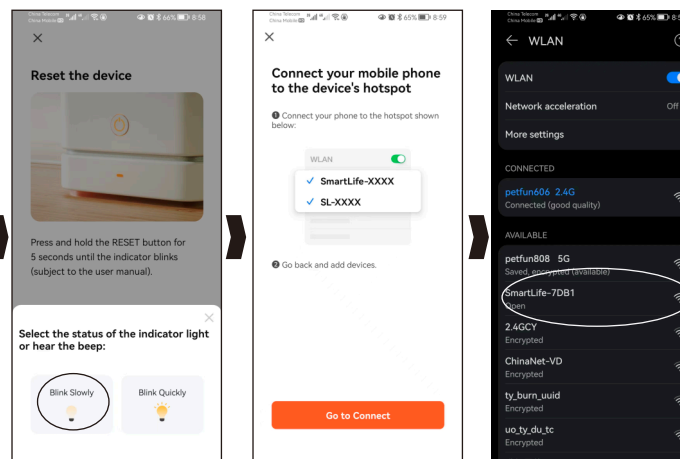
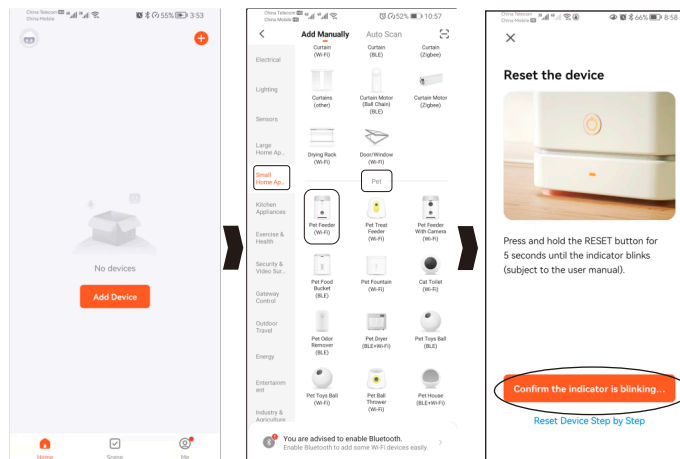

**The device should be placed near the router.
Plug in the adapter and switch on the power.**

Method 2: AP Mode

Open the App, and Click "+" Button, Pop-up Device List,

1. Select "Small Home Ap...",
2. Select "Pet",
3. Select "Pet Feeder (Wi-Fi)".
4. Select the 2.4GWi-Fi network and enter the password (5G network is not supported).
5. Confirm that the green indicator of the equipment flashes slowly;
6. Reset the equipment (Long press the "SET", release your hand after the beep, the device reset successfully);
7. Select "smartlife xxxx" in the network list to connect;
8. Return to the app and the device starts networking.

Feeding

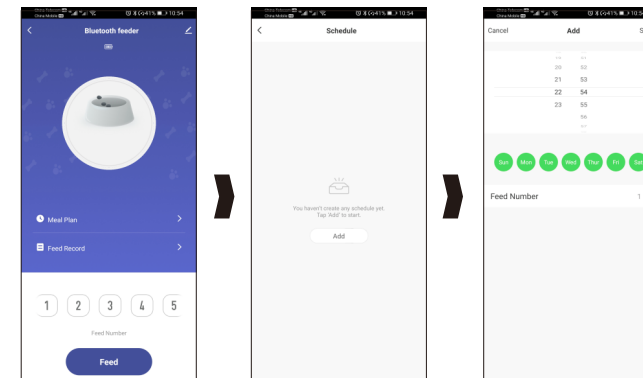

Manual Feed

1. Click "Feed"
2. Choose the number of servings according to pet habits.
3. Click "Feed"
4. About 7g per serving of food.
5. "Feed Records", browse historical feeding records

Automatic Feed

1. Click "Schedule"
2. Click "Add"
3. Set automatic feeding time and repeat date
4. Choose the number of servings according to pet habits
5. Click "Save" to Save the Settings
6. About 7g per serving of food.

Setting

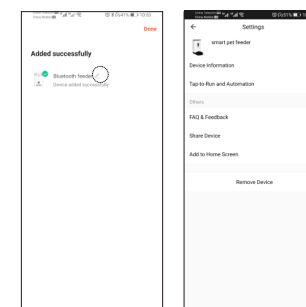

1. Click "Settings" in the upper right corner of the video page to enter the settings. Set the page.

2. Set the device as needed on the settings page.

3. On the settings page, click "remove device", the equipment is set up at the factory, the equipment removed from App, re-enable the device to follow the operation method is reconnected.

Kind Notice:

1. Only support 2.4GHz wifi network.
2. About 10g per portion (Different kinds of food, different weights.).
3. Suitable for dry food only and the food size should be $\leq 14\text{mm}$.
4. Remember to replenish food when the food is not enough.